

CONFALONIERI Maniglia incasso

ART.999

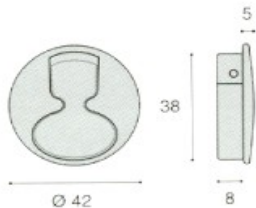

ART.	Finitura	PZ. Conf.	EURO
MI999ONS	Nichelato satinato	50	
MI999ON	Cromato	50	
MI999OL	Oro lucido	50	

ART. 9045



ART.	Finitura	PZ. Conf.	EURO
MI 9045 A AO	Argento 7 opaco	50	
MI 9045 B AO	Argento 7 opaco	25	

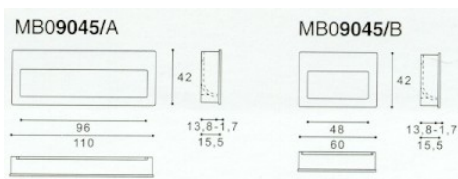

ART. 9046



ART.	Finitura	PZ. Conf.	EURO
MI 9046 AO	Argento 7 opaco	20	

Scasso L 200 H 160 PR. 14.5

ART.9052



ART.	Finitura	PZ. Conf.	EURO
MI 9052 AO	Argento 7 opaco	25	

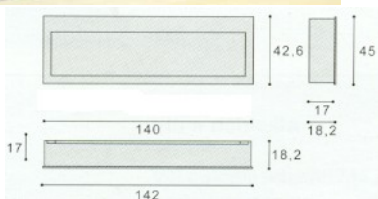

ART. 9078

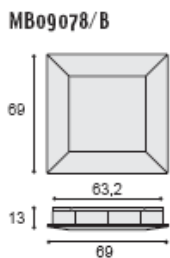

ART.	Finitura	PZ. Conf.	EURO
MI 9078BAR	Argento 7 opaco	25	

Maniglie incasso per porte scorrevoli

ART. MTS S.FORO

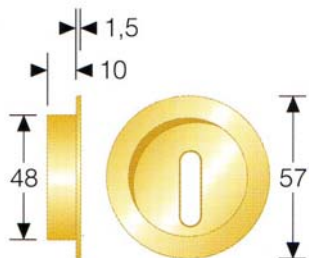

CONSIGLIATA PER PORTE SCORREVOLI

ART.MTC C.FORO CHIAVE



ART.	Finitura	Conf.	Euro €
	ART. MTS SENZA FORO CHIAVE	1/24	
MIMTSOL	Ottone lucido	1/24	
MIMTSOB	Ottone bronzato	1/24	
MIMTSON	Cromo lucido	1/24	
MIMTSONS	Cromo satinato	1/24	
MIMTSOS	Ottone satinato	1/24	
	ART. MTC CON FORO CHIAVE		
MIMTCOL	Ottone lucido	1/24	
MIMTCOB	Ottone bronzato	1/24	
MIMTCON	Cromo lucido	1/24	
MIMTCONS	Cromo satinato	1/24	

ART. MTG



ART.	Finitura	Conf.	Euro €
MIMTG48OL	Ottone lucido	1/24	
MIMTG48OB	Ottone bronzato	1/24	
MIMTG48ON	Cromo lucido	1/24	
MIMTG48ONS	Cromo satinato	1/24	
MIMTG48OS	Oro satinato	1/24	

CONSIGLIATA PER PORTE PIEGHEVOLI A LIBRO / SCORREVOLI

ART. MMF

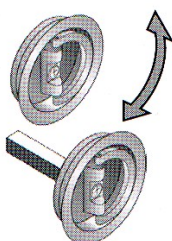
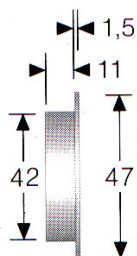

ART.	Finitura	Conf.	Euro €
MIMMFOL	Ottone lucido	24	
MIMMFOCS	Cromo lucido	24	

Kit per 1 porta



CONSIGLIATA PER PORTE PIEGHEVOLI A LIBRO

ART. MOS



ART.MOC

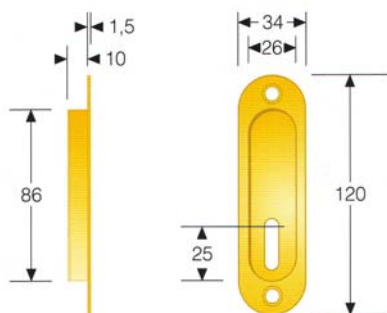

ART.	Finitura	Conf.	Euro €
MIMOSOL	Ottone lucido	1/24	
MIMOSOB	Ottone bronzato	1/24	
MIMOSON	Cromo lucido	1/24	
MIMOSONS	Cromo satinato	1/24	
	ART. MOC CON FORO CHIAVE		
MIMOCOL	Ottone lucido	1/24	
MIMOCOB	Ottone bronzato	1/24	
MIMOCON	Cromo lucido	1/24	
MIMOCONS	Cromo satinato	1/24	

ART. MTT

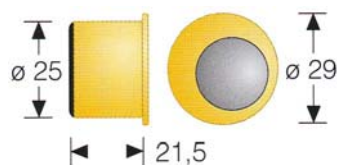
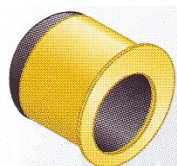

ART.	Finitura	Conf.	Euro €
DIMTTOL	Ottone lucido	1/12	
DIMTTOB	Ottone bronzato	1/12	
DIMTTON	Cromo lucido	1/12	
DIMTTONS	Cromo satinato	1/12	
DIMTTOS	Ottone satinato	1/12	